

TG Series Solenoid and Pilot Valve

We have variety of solenoid and pilot valves, available in different configurations, 5/2, 5/3, 3/2 with different port sizes. The material used is aluminium and engineering plastic. These valves can be used in different conditions and in combination with various control elements.



239, Gobind Udyog Bhavan, Model Town
Mulund(W), Mumbai-400080
Tel.: +91-2221641896, 21645737
Mobile No.: +91-9594451155
Email: info@honeytech.in . Website: www.honeytech.in

TG Series Solenoid Valve



Features

- Pneumatic valve controlled by micro electric signal
- Long service life
- Manual over ride
- Wide range of coil voltage available Robust in construction
- Suitable for manifold mounting

Order Code

TG	25	1	1	06	C	AC220V
Series	Valve Type	Body Size	Control Form	Port Size	Working mode	Coil Voltage
	25: 2 Position/5 ports 35: 3 Position/5 Ports	1 2 3 4	1: Single solenoid operated 2: double solenoid operated	06: G1/8" 08: G1/4" 10: G3/8" 15: G1/2"	blank: 2 position C: 3 position-center closed	DC 12V DC 24V AC 110V AC 220V

COIL		G2511CT*	G2521CL
Voltage	AC	220v, 50 Hz	
	DC	24V	
Allowable Voltage Range		± 10% (for AC), ± 2% (for DC)	
Insulated Class		Class B	
Duty Cycle		Continuous	
Power Consumption	AC	4VA	5VA
	DC	2.6 W	4.8 W
Surge Voltage Suppressor		AC: VARISTOR, DC: DIODE	
Indicator Light		LED	

*COIL ONLY FOR TG2511-06 AND TG2512-06

Check point

- 1) check the piece physically once before installation
- 2) verify the input voltage supply and coil voltage rating
- 3) insert the air supply pipes according to the symbols marked
- 4) before operating valve with electrical connections check it once using manual override button to verify direction of flow of air
- 5) on the exhaust port install silencers and make sure that surrounding area should be dust free
- 6) any kind of foreign particle observed in fitting or air pipe should be removed immediately

Technical Parameter

Specification Item	Valve Type	Port Size	Nominal Diameter (mm)	Applicable Medium	Applicable Pressure Range	Design	Recommended Oil For Lubrication	Applicable Temperature
TG2321-08	2 Positions/ 3 Ports	G1/4"	8	Compressed Air, Dry, Filtered and Lubricated	1.5 - 8 Kg/cm ²	Spool Type (Internally Piloted)	ISO VG32 (Servo System 32)	5-60°C
TG2331-10		G3/8"	10					
TG2341-15		G1/2"	15					
TG2511-06	2 Positions/ 5 Ports	G1/8"	6					
TG2512-06		G1/8"	6					
TG2521-06		G1/8"	6					
TG2522-06		G1/8"	6					
TG2521-08		G1/4"	8					
TG2522-08		G1/4"	8					
TG2531-10		G3/8"	10					
TG2532-10		G3/8"	10					
TG2541-15		G1/2"	15					
TG2542-15	3 Positions/ 5 Ports	G1/2"	15					
TG3522-08C		G1/4"	8					
TG3532-10C		G3/8"	10					
TG3542-15C		G1/2"	15					

TG Series Solenoid Valve

2 Positions / 3 Ports Solenoid Valve

TG2321-08

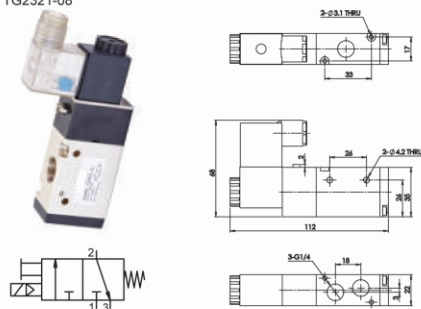

2 Positions / 3 Ports Solenoid Valve

TG2331-10

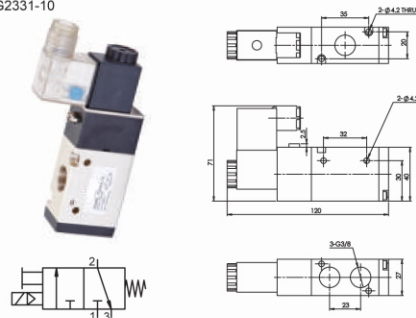

2 Positions / 3 Ports Solenoid Valve

TG2341-15

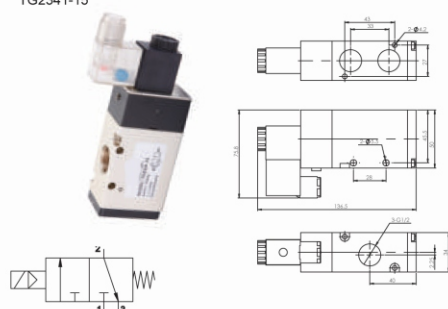

2 Positions / 5 Ports Solenoid Valve

TG2511-06

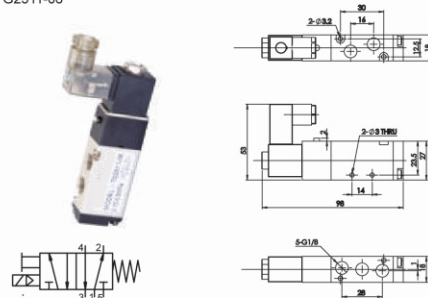

2 Positions / 5 Ports Solenoid Valve

TG2512-06

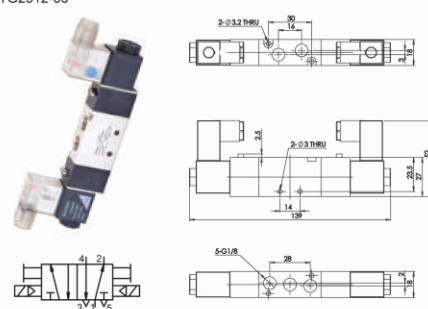

2 Positions / 5 Ports Solenoid Valve

TG2521-06

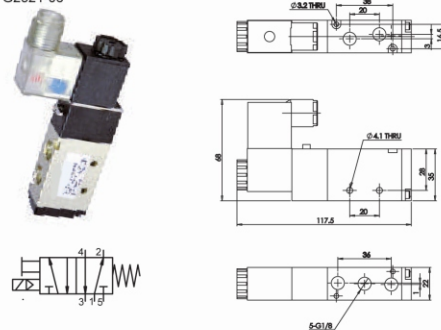

2 Positions / 5 Ports Solenoid Valve

TG2521-08

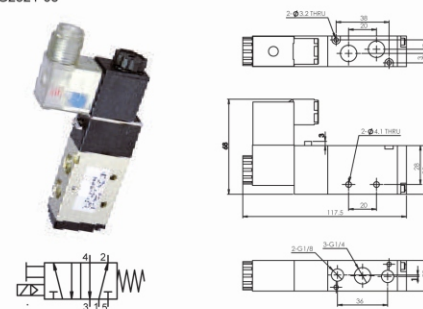

2 Positions / 5 Ports Solenoid Valve

TG2522-06

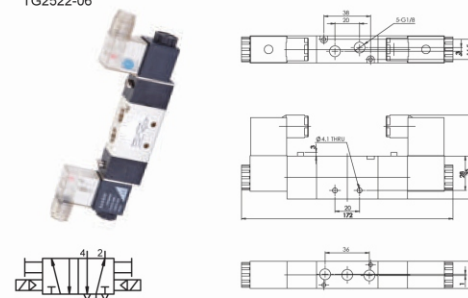

2 Positions / 5 Ports Solenoid Valve

TG2532-10

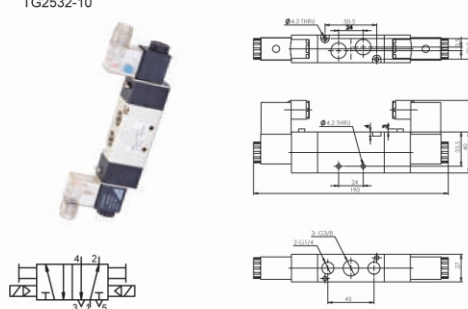

2 Positions / 5 Ports Solenoid Valve

TG2522-08

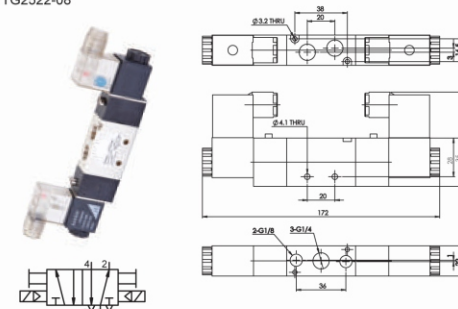

2 Positions / 5 Ports Solenoid Valve

TG2531-10

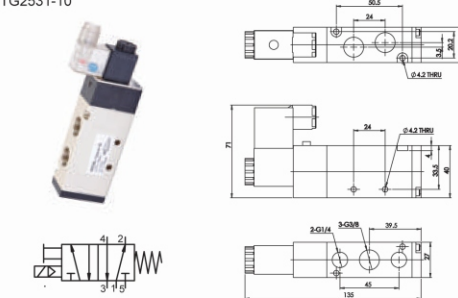

2 Positions / 5 Ports Solenoid Valve

TG2541-15

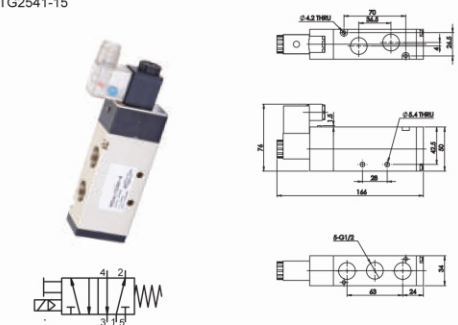

TG Series Solenoid Valve

TG Series Solenoid Valve

2 Positions / 5 Ports Solenoid Valve

TG2542-15

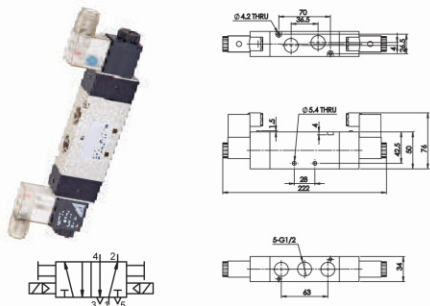

3 Positions / 5 Ports Solenoid Valve

TG3512-06C

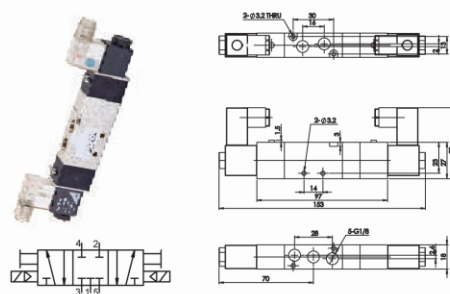

3 Positions / 5 Ports Solenoid Valve

TG3522-08C

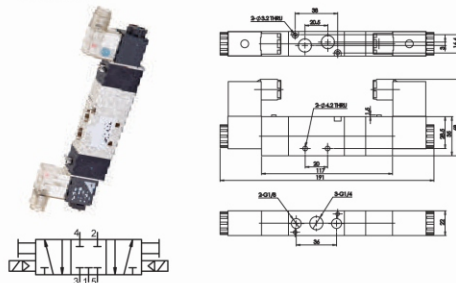

3 Positions / 5 Ports Solenoid Valve

TG3532-10C

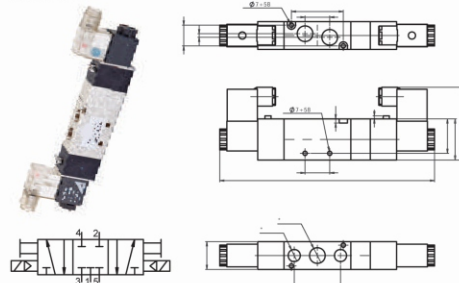

3 Positions / 5 Ports Solenoid Valve

TG3542-15C

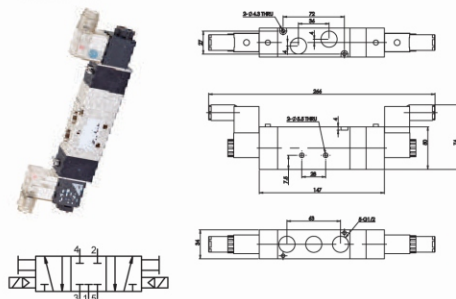

TG Series Solenoid Valve

2 Positions / 2 Ports, 2 Positions / 3 Port Solenoid Valve

Order Code

TG

Series

22

Valve Type

22: 2 Position/ 2 Ports
23: 2 Position/ 3 Ports

06

Port Size

06: G1/8"
08: G1/4"

AC220V

Coil voltage

DC 12V
DC 24V
AC 110V
AC 220V

Item Specification	Valve Type	Port Size	Nominal Diameter	Applicable Medium	Applicable Pressure Range	Recommended Oil For Lubrication	Applicable Temperature
TG22-08	2 Position / 2 Ports	G1/4"	8	Compressed Air, Dry, Filtered And Lubricated	1.5 - 8 Kg/Cm ²	ISO VG32 (SERVO SYSTEM 32)	5- 60°C
TG23-06	2 Position / 3 Ports	G1/8"	6				
TG23-08		G1/4"	8				
TG23-06E		G1/8"	6				

TG22-08

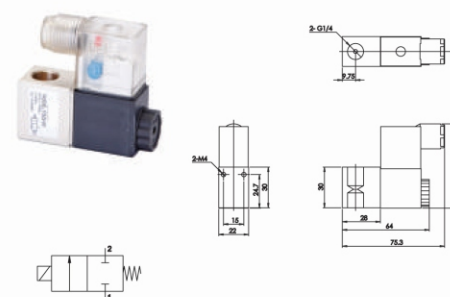

TG23-06

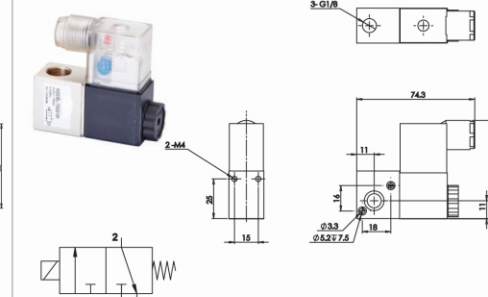

TG23-08

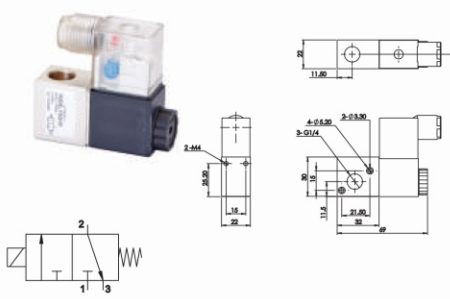

TG23-06E

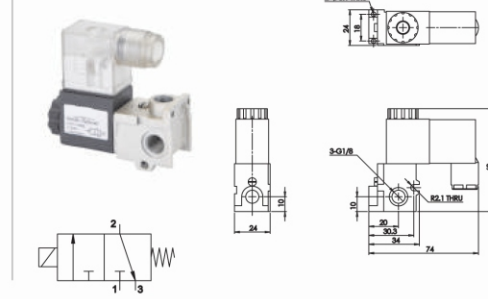

VT Series High Frequency Valve

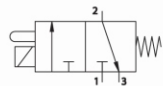

Order Code

VT307	02	AC220V
Series High Frequency Valve	Port Size 02: G1/4"	Coil Voltage DC 24V AC 110V AC 220V



Solenoid Coil Specifications

Plug Mode	Grommet
Rated Voltage	AC: 110V, 220V (50Hz); DC: 24V
Allowable Voltage Fluctuation	± 10 %
Insulated Grades	Class B
Power Consumption	AC Start: 12.7 VA Keep on 7.6 VA DC 4.8W

Specifications

Applicable fluid	Compressed Air, Dry, Filtered and Lubricated
Medium Temperature	-5 - 60°C
Response Time	Max 20 Millisec
Max action frequency	10 Cycles / Sec
lubrication	Servo System 32
Manual Override	Non-locking Push Type
Enclosure	Dustproof
Pressure Range	0 To 8 Kg/cm ²
Port Size	G1/4"

Overall Dimension

VT 307

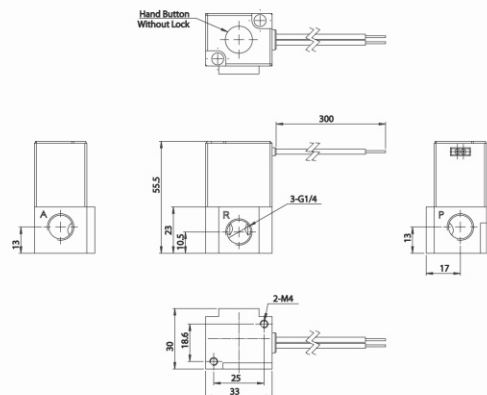

TG Series High Pressure Solenoid Valve

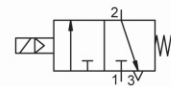

Order Code

TG23HP	~08	AC220V
Series High Pressure valve series	Port size 08: G1/4" 15: G1/2"	Coil Voltage DC 24V AC 220V



Features

- Highly sensitive to the micro signals.
- Robust design.
- Can be use for pressure upto 24 bars.
- Applications-high pressure pneumatic equipments such as blow bottle machine, equipments which produces special shapes.

Technical Parameter

specification\model	TG23HP-08	TG23HP-15
medium	COMPRESSED AIR - DRY, FILTERED AND LUBRICATED	
Applicable temperature	~5 to 60°C	
Pressure Range	1.5 to 24 Kg/Cm ²	
Recommended oil For lubrication	ISO VG32 (SERVO SYSTEM 32)	
Nominal Diameter (mm)	8	15
Port Size	G1 / 4"	G1 / 2"

Overall Dimension

TG23HP-08

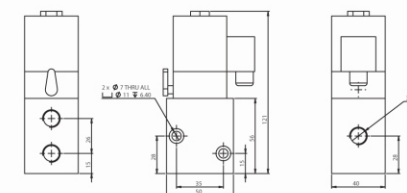

TG23HP-15

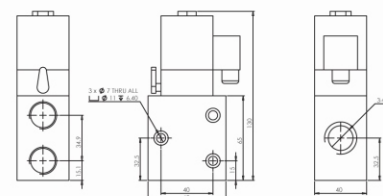

TG Series Pilot Valve



Features

- Simple in Structure
- Robust Design
- It is Controlled by the Pneumatic Signal
- Highly sensitive to the Pneumatic Signal
- Reliable and easy operations

Order Code

TG **25** **1** **1A** **06**

Series

Valve type

23: 2 Position/ 3 Ports
25: 2 Position/ 5 Ports

Body Size

1
2
4

Control Form

1A: Single Pilot
Operated
2A: Double Pilot
Operated

Port Size

06: G1/8"
08: G1/4"
15: G1/2"

Application:

- These type of Valves are applicable to the places where the existence of power is forbidden. It is widely applied to the inflammable and explosive places such as coal hill, mines, natural gas etc.

Technical Parameter

Specification Model	Valve Type	Port Size	Pilot Port Size	Nominal Diameter (mm)	Applicable Medium	Applicable Pressure Range		Design	Recommended Oil For Lubrication	Applicable Temperature
TG2321A-08	2 Position/ 3 Ports	G1/4"	G1/8"	8	Compressed Air, Filtered, Lubricated	1.5-8 Kg/Cm ²	2-3 Kg/Cm ²	Spool Type	ISO VG32 or Servo System 32	5° - 60° C
TG2511A-06		G1/8"		6						
TG2512A-06		G1/8"		6						
TG2521A-08		G1/4"		8						
TG2522A-08	2 Position/ 5 Ports	G1/4"	G1/8"	8	Compressed Air, Filtered, Lubricated	1.5-8 Kg/Cm ²	2-3 Kg/Cm ²	Spool Type	ISO VG32 or Servo System 32	5° - 60° C
TG2541A-15		G1/2"		15						
TG2542A-15		G1/2"		15						

Overall Dimension

2 Positions / 3 Ports Air Valve

TG2311A-08

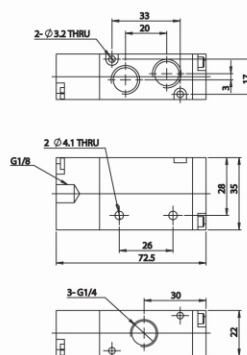
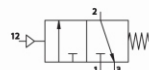

TG Series Pilot Valve

2 Positions / 5 Ports Air Valve

TG2511A-06

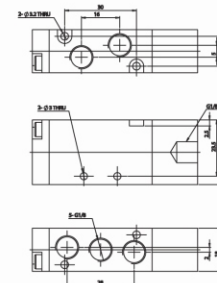

2 Positions / 5 Ports Air Valve

TG2512A-06

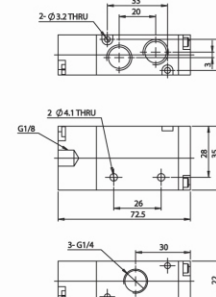
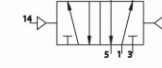

2 Positions / 5 Ports Air Valve

TG2521A-08

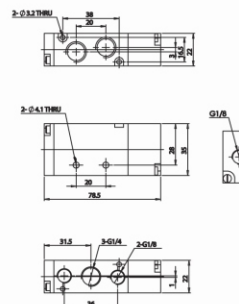
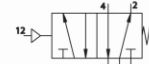

2 Positions / 5 Ports Air Valve

TG2522A-08

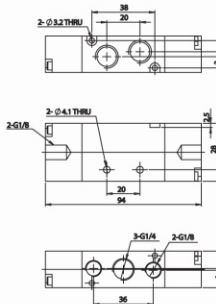

2 Positions / 5 Ports Air Valve

TG2541A-15

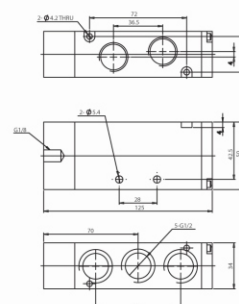
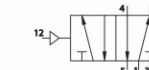

2 Positions / 5 Ports Air Valve

TG2542A-15

